

ÜBERSICHT

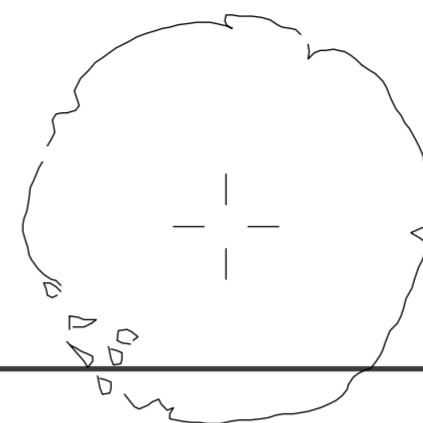
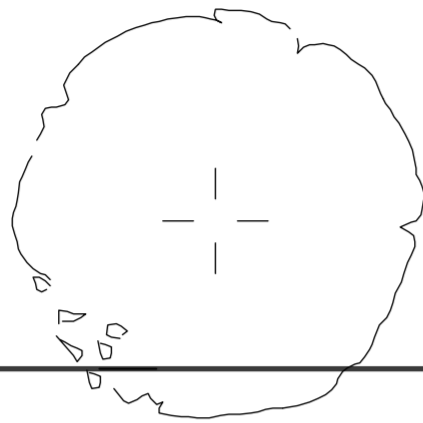
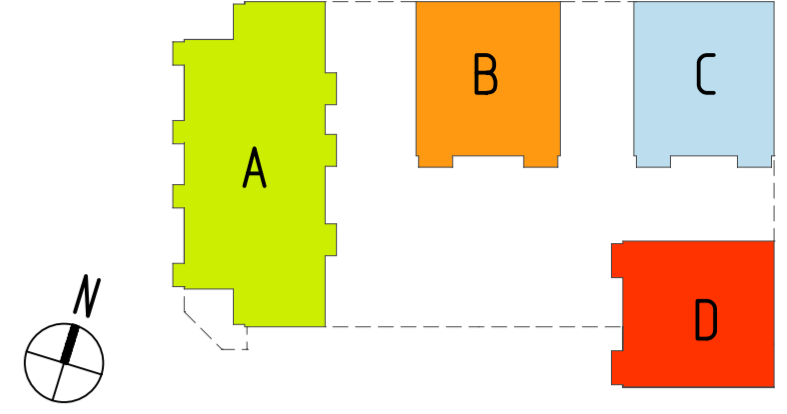

WHG B.2.1  
34,33 m<sup>2</sup>

WHG B.2.4  
34,65 m<sup>2</sup>

WHG C.2.1  
33,39 m<sup>2</sup>

WHG B.2.2  
128,46 m<sup>2</sup>

WHG B.2.3  
129,29 m<sup>2</sup>

WHG C.2.2  
126,78 m<sup>2</sup>

WHG A.2.4  
60,94 m<sup>2</sup>

WHG A.2.5  
60,94 m<sup>2</sup>

WHG A.2.6  
60,94 m<sup>2</sup>

PLANSTAND		DATUM	02.12.2014
PROJEKT	NEUSTADT CARRÉ KOMMENDIERESTRASSE, 49074 OSNABRÜCK		PROJEKTNUMMER 2013-022
BAUHERR	 <b>MBN Bau AG</b> BEEKEBREITE 2, 49124 GEORGSMARIENHÜTTE		BEARBEITER GB
PLANUNG	<b>PLAN.CONCEPT</b> ARCHITECTEN GmbH HEINRICHSTRASSE 14C 49080 OSNABRÜCK TELEFON 0541 / 98224-0 49080 OSNABRÜCK DIPL.-ING. ARCHITECTIN FAX 0541 / 98224-44 AFRA CREUTZ		DATUM
ENTWURFSVERFASSER			UNTERSCHRIFT
PLANINHALT	2. OBERGESCHOSS HAUS B		MASSSTAB 1 : 100
	PLANNR 512	BLATT DIN A2	